

# Owner's Manual

### Under Sink Inline Filter kit contains:

- A** ULTRAFILTRATION  filter
- B** Flexible connecting pipe
- C** Connector fittings
- D** Teflon tape

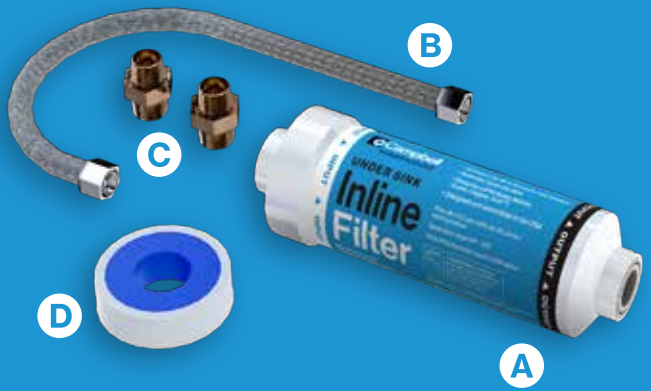

- If this device is not maintained and operated as specified in the owner's manual there is a risk of exposure to contaminants.
- System installation must comply with state and local laws and regulations.
- Do not use with water that is micro-biologically unsafe or of unknown quality without adequate disinfection before or after the system.
- Rated for 95% reduction of PFOA/PFOS to 150 gallons. Replace cartridge at that time or sooner if a noticeable reduction in flow rate occurs.
- Systems certified for cyst reduction may be used on disinfected waters that may contain filterable cysts.

### Prepare Your Filter

- 1** Wrap Teflon tape around the threads of the supplied fittings to help prevent leaks.
- 2** Insert the connector fittings into each end and hand tighten.
- 3** Using a wrench, gently tighten the fittings until snug and then 1/4 turn more. **DO NOT OVER TIGHTEN.** Repeat this for the other fitting.



**WARNING:** This system is for use on water supplies that have been treated to public water systems standards. This system has been tested to demonstrate effective reduction of microcystins, however, in the event of a reported cyanotoxin event in your water supply, other cyanotoxins may be present in the drinking water which may not be effectively reduced by this system. In the event of a cyanotoxin notification, follow the recommendations of your drinking water authority.

1

Identify the cold water input valve and the existing pipe to the faucet.

Shut off the cold water to the faucet.

TURN TO THE OFF POSITION (RIGHT)

FLOW TO THE FAUCET →

2

Disconnect the existing flexible pipe connector from the cold water valve.\*

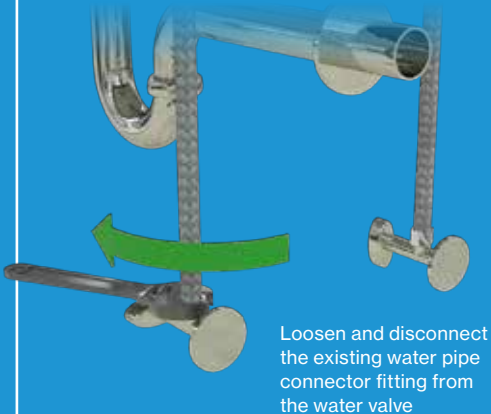

Loosen and disconnect the existing water pipe connector fitting from the water valve

\*NOTE: If your cold water connector pipe is not flexible, it may be necessary to replace it with or add a flexible connector pipe similar to the one supplied.

3

Install the filter unit using the supplied flexible water pipe connector and the existing flexible connector.

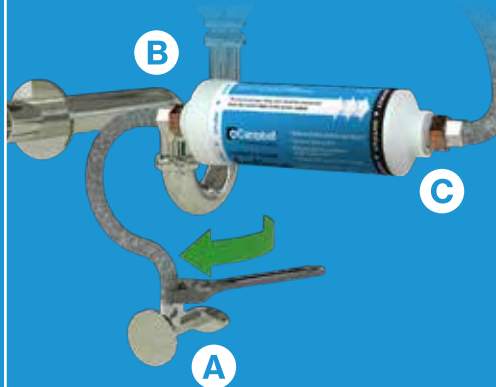

**A** Connect the new filter flexible connector fitting to the water valve. **B** Connect the new water pipe connector to the input end of the filter. **C** Connect the open end of the existing flexible pipe connector to the output end of the filter fitting. **Do not over tighten.**

4

Turn on the cold water valve.



5 Turn the water valve to the **ON** position (left) to start the water flow through the filter. **CHECK FOR LEAKS.**

6

Let the water flow for **2 minutes** to flush the filter. Enjoy clean, safe water where you need it most.